



PRODUCT CATALOGUE

machinery specialists since 1968



LIFTING
AUTOMOTIVE



PROUD PRODUCT
SPONSOR

PRODUCT INDEX

LIFTING EQUIPMENT

	Item No:	Page
RACING JACKS	SIP 1.5 Ton Aluminium Racing Jack	03694 4
	SIP 2.5 Ton Aluminium/Steel Racing Jack	03697 4
TROLLEY JACKS	SIP 3 Ton Trolley Jack	03699 5
	SIP 3 Ton 'Quick-Lift' Trolley Jack	03676 5
LOW-PROFILE TROLLEY JACKS	SIP 2.5 Ton 'Low-Profile' Trolley Jack	03675 6
	SIP 3.25 Ton 'Low-Profile' Trolley Jack	03688 7
LONG FLOOR JACKS	SIP 5 Ton Long Floor Jack	03642 8
	SIP 10 Ton Long Floor Jack	03647 8
PNEUMATIC FLOOR JACKS	SIP 22 Ton Pneumatic Floor Jack	03643 9
	SIP 50/25/10 Ton Pneumatic Truck Jack	03649 9
TRANSMISSION JACKS & ADAPTORS	SIP Transmission Adaptor	03869 10
	SIP 500 KG Transmission Jack	03871 10
	SIP 500 KG 'Fast-Lift' Transmission Jack	03690 10
	SIP 1 Ton Transmission Jack with Adaptor	03693 11
JACK STANDS	SIP 3 Ton Jack Stands - Ratchet	03637 11
	SIP 6 Ton Jack Stands - Ratchet	03641 11
BOTTLE JACKS	SIP 2 Ton Bottle Jack	03666 12
	SIP 4 Ton Bottle Jack	03667 12
	SIP 8 Ton Bottle Jack	03668 12
	SIP 12 Ton Bottle Jack	03669 12
	SIP 20 Ton Bottle Jack	03670 12
	SIP 30 Ton Bottle Jack	03671 12
ENGINE CRANES & LEVELLER	SIP 50 Ton Bottle Jack	03672 12
	SIP 1 Ton Engine Crane	03685 13
	SIP 2 Ton Engine Crane	03687 13
	SIP Engine Leveller	03692 13



AUTOMOTIVE EQUIPMENT

	Item No:	Page
ENGINE STAND & GARAGE EQUIPMENT	SIP 340 KG Engine Stand	03681 14
	SIP Car Wheel Dollies	03833 14
	SIP Car Creeper	03639 14
	SIP Wheel Chocks	03636 14
	SIP Wheel Removal Trolley	03640 15
	SIP Hydraulic Spring Compressor	03638 15
HYDRAULIC EQUIPMENT	SIP 10 Ton Bench Press	03650 16
	SIP 12 Ton Shop Press	03651 16
	SIP 20 Ton Shop Press	03689 16
	SIP 30 Ton Shop Press	03695 16
	SIP 45 Ton Shop Press	03691 17
	SIP 75 Ton Shop Press	03696 17
PARTS WASHERS	SIP 10 Ton Auto Body Repair Kit	03679 18
	SIP 12 Ton Hydraulic Pipe Bender	03683 18
	SIP Professional Torque Multiplier	06451 18
SOLVENT & OIL	SIP 5 Gallon Parts Washer	06886 19
	SIP 20 Gallon Parts Washer	03834 19
	SIP Sand Blast Cabinet	03868 19
	SIP Parts Washer Solvent	02382 19
OIL DRAINERS	SIP Advanced Hydraulic Oil	02347 19
	SIP 80 Litre Gravity Oil Drainer	03700 20
	SIP 80 Litre Gravity/Suction Oil Drainer	03711 20
	SIP 80 Litre Gravity/Suction Oil Drainer with Inspection Chamber	03722 21
BOOSTER POWER PACKS	SIP Rescue Pac 1600 - 12 V	03936 22
	SIP Rescue Pac 3000 - 12 / 24 V	03937 22
	SIP Pro Booster 802Li - 12 V	03973 22
	SIP Pro Booster 2513 - 12 V	07172 23
	SIP Pro Booster 3100 - 12 V	07173 23
	SIP Pro Booster 5024 - 12 / 24 V	07192 24
	SIP Pro Booster 6200 - 12 / 24 V	07174 24
	SIP SC Booster 9000 Capacitor - 12 V	07199 24
	SIP Chargestar 100BSU - 12 V	07182 25
	SIP Chargestar Smart 4	03979 26
	SIP Chargestar Smart 8	03980 26
	SIP Chargestar Smart 18	03981 27
	SIP Chargestar T27	03982 27
	SIP Chargestar Auto 40	03974 28
BATTERY CHARGERS	SIP Chargestar P24	05530 29
	SIP Chargestar P32	05531 29
	SIP Startmaster P300	05532 30
	SIP Startmaster P440	05533 30
	SIP Startmaster PW520	05534 31
	SIP Startmaster PW600	05536 31
	SIP Startmaster PW760	05537 31
	SIP Startmaster PWT1000	05538 31
	SIP Startmaster PWT1400	05539 31
	SIP Startmaster PWT5000 Digital	05542 32

BLOODHOUND SSC ENGINEERING ADVENTURE



SIP Industrial Products are incredibly proud to provide multiple product sponsorship for the Bloodhound SSC project, a British-based supersonic car aiming to smash the land speed record in pursuit of 1000mph, with trials already underway. SIP are fully behind this inspiring event. For more information, visit sip-group.com

PROUD PRODUCT SPONSOR

WE ARE SIP

SIP Industrial Products...

***Providing our customers with expertise,
quality and choice since 1968***

SIP Industrial Products have become a flagship supplier of high quality equipment and machinery for a range of different industries, and even though we're 50 years old, it's a value we have upheld since day one. With that in mind, SIP are proud to supply and service the ever-growing industries of engineering, construction, automotive and agricultural marketplaces, just to name a few.

While we may have made our name for being renowned specialists in welding, metalworking, and compressed air products, it is our automotive range that is our most up-and-coming. The range is constantly being upgraded and refined to ensure that whatever the task at hand is, SIP stock a heavy-duty product to complete the job while performing to the highest possible standard.

Our Lifting and Automotive range caters to all applications, whether for a busy automotive garage and workshop, mobile maintenance, roadside recovery, or general domestic repair. It is suited for all levels of performance, from compact and lightweight trolley jacks through to pneumatically-operated industrial shop presses.

SIP stock a number of heavy-duty air jacks, bottle jacks, jack stands, shop presses and trolley jacks, as well as a large variety of shop equipment, including; wheel transport equipment, body repair kits, engine cranes, transmission jacks, oil drainers, and much more.

We are dedicated to making sure you get the right product model for the task at hand, and we will do everything we can to assist you in making the right decision. All this is backed up by our world-class service and engineering technicians at our headquarters near Loughborough, Leicestershire.

Reliable equipment, value, and choice make SIP Industrial Products the machinery specialists today, just as it was 50 years ago.



1968

SIP Incorporated started selling abrasive discs, cutting blades and metal cutting machines

1976

ARC/MMA production set up in UK and spot welder range launched



1981

SIP established as market leaders in portable ARC/MMA welders

1985

Pioneering portable MIG welder range introduced

1989

Full range of Air Tools launched

1991

Launch of Woodworking range

1992

Launch of Pressure Washer range

1968

1972

Introduced pioneering air cooled ARC/MMA welders introduced into the range

1979

Full range of wheel mounted MIG welders launched

1980



Success leads to new premises located near M1 motorway

1988

20 YEARS of success celebrated

SIP INDUSTRIAL PRODUCTS LIMITED

SIP began life as a small operation selling cut industrial abrasives, circular metal cutting saws and blades to a handful of distributors from two very small units on Radnor Road, Wigston, in the heart of Leicester.

This operation grew and cemented SIP as a respected local firm, and fuelled a period of expansion, which, in turn, allowed SIP to fill empty gaps in the market and give customers everything that they needed.

This is showcased through bringing in outside ARC/MMA welders in to our full range in 1972 - just 4 years into trading. This made the remainder of the 70s very prosperous, and saw the launch of an in-house production of ARC/MMA welders and a new range of wheel-mounted MIG welders. SIP were launching new welders and equipment whilst always at the forefront of technology, and soon added air direct and belt-drive air compressors to their collection in 1977.

The SIP range of ARC/MMA welders established SIP as market leaders and in 1981 - shortly after moving into a new purpose built 65,000ft² plant in Shepshed, Leicestershire, just off J23 of the M1. The company as a whole had become a flagship firm, the go-to for good quality craftsmanship and engineering, and a respected name among merchants, distributors and tradesmen alike.

As well as supplying customers across the UK, SIP soon opened their dedicated department for Export, supplying to the likes of Australia and the U.S. by the end of the 1980s, and into 20 countries worldwide by 1996. During this time,

SIP had expanded their stock range and by the early 1990s, air tools, woodworking machinery and pressure washers had all been added. A further extension in 1994 to their headquarters in Leicestershire meant SIP could grow the business further.

By the turn of the millennium, SIP were already 32 years old, but the next years would prove instrumental to the success of SIP. That very same year, SIP sold their landmark 250,000th welder, and just three years of hard work later, SIP had doubled their customer base.

All this experience sees SIP still at the pinnacle of technology and engineering, and continuing to provide user-friendly, top quality products and an efficient, straightforward after-sales support service. Recent years have included an entire new range of air compressors - the largest in the UK - with a full range of 10,000 spare parts to service and support these and everything else that we stock.

After 50 years, SIP, have not slowed down. This year sees the roll-out of dedicated service vehicles, so we are able to come and visit

the customer on-site to make sure your SIP equipment is performing as it did when it left the factory. It's also seen the launch of SIP's 1000th product!

Continuing on this growth path, SIP will have sold in excess of 5,000,000 products by the end of 2018.

A lot has changed since 1968. Something that has stayed exactly the same is the SIP commitment to manufacturing and supplying machinery and equipment, from welders to lights to booster packs, to people around the UK and worldwide. SIP still take the utmost care and are constantly striving to provide quality, value and choice.

SIP Industrial Products - 50 years and counting!

SIP TIME-LINE

1997

Production of engine driven generators expanded

2002

Woodworking range increased

2003

SIP doubles its number of customers

2010

New advanced range of ProTech Inverter welders launched with extended warranty

2014

Over 10,000 spare parts in stock to serve the range

2018

SIP will have sold in excess of
5,000,000
products in its history



2018.....

1996

SIP sell to over 20 countries worldwide

2000

250,000th welder sold

2009

NEW complete range of air compressors launched - Largest in UK

2013

Launched SIP website and social media

2017

Product sponsorship for THE BLOODHOUND Project, 1000mph speed record attempt

1998

30 YEARS of success celebrated

2008

40 YEARS of success celebrated

2016

1000th SIP product launched. Service vans added for on-site servicing



TROLLEY JACKS ALUMINIUM

SIP 1.5 Ton Low-Profile Aluminium Racing Jack ITEM NO: 03694

An ultra-lightweight and compact trolley jack suitable for both workshop and roadside/track applications due to its low-profile build. Ideal for lower vehicles such as performance and racing cars. Constructed from aircraft-grade aluminium.

Key Features:

- Ultra low-profile design for improved access with performance vehicles
- Dual pump system reliability
- Front roller wheel and rear castors for easy movement
- Large saddle with rubber contact pad
- Side carry handles for transport



Dual pump system



SIP 2.5 Ton Low-Profile Aluminium/Steel Racing Jack ITEM NO: 03697

A solid trolley jack manufactured from aluminium and steel components, with lower clearance for performance and racing cars. Easily transportable, and ideal for mobile applications.

Key Features:

- Low-profile design for lower clearances
- Durable aluminium and steel construction
- Quick-Lift system for fast operation/less strain
- Front roller wheel and rear castors for easy movement
- Side carry handles for easy lifting and storage

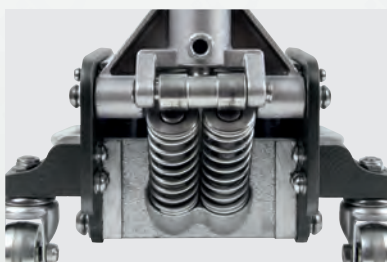

Dual pump system



MODEL	SIP 1.5 TON ALUMINIUM RACING JACK	SIP 2.5 TON ALUMINIUM/STEEL RACING JACK
PRODUCT CODE	03694	03697
Lifting Capacity	1.5 Ton	2.5 Ton
Min. Lifting Height	80 mm	75 mm
Max. Lifting Height	375 mm	440 mm
Saddle Size	100 mm	100 mm
Construction	Aluminium	Aluminium / Steel
Low-Profile Design	✓	✓
Quick-Lift Feature	✗	✓
Wheel Mounted	✓	✓
Weight	13.2 kg	26 kg
Packaged Dimensions	80 x 290 x 510 mm	170 x 710 x 295 mm
Barcode Number	5012713036226	5012713036240

SIP 3 Ton Trolley Jack ITEM NO: 03699

A heavy-duty trolley jack, with a patented design, specifically designed for prolonged and intense use. Strong extra-large components allow for easy lifting of large weights. Suitable for professional applications.

Key Features:

- Powerful and highly reliable
- Premium quality patented design
- Extra-large saddle and rubber pad
- Heavy-duty wheels and castors
- Extra-strong long handle
- Heavy-duty gauge base



SIP 3 Ton 'Quick-Lift' Trolley Jack ITEM NO: 03676

A durable trolley jack featuring a steel hydraulic assembly and dust seals, allowing for heavy-duty use and added reliability. This jack, like others, is fitted with a Quick-Lift lifting mechanism.

Key Features:

- Quick-Lift system for fast operation/less strain
- Removable 2-piece handle with rubber grip
- Steel hydraulic assembly and dust seals
- Strong rear wheels and front castors
- Extra-large saddle and rubber pad
- Solid and durable construction



"...SIP jack impressed us with their twin-piston hydraulics and accurate quick-lift systems..."

WHAT IS QUICK-LIFT?

The Quick-Lift system allows the quick raising of the jack saddle to the vehicle lifting point with minimal effort, therefore reducing overall operator strain and increasing efficiency.

MODEL	SIP 3 TON TROLLEY JACK	SIP 3 TON 'QUICK-LIFT' TROLLEY JACK
PRODUCT CODE	03699	03676
Lifting Capacity	3 Ton	3 Ton
Min. Lifting Height	135 mm	135 mm
Max. Lifting Height	495 mm	495 mm
Saddle Size	120 mm	122 mm
Construction	Steel	Steel
Low-Profile Design	✗	✗
Quick-Lift Feature	✗	✓
Wheel Mounted	✓	✓
Weight	34 kg	34 kg
Packaged Dimensions	215 x 390 x 695 mm	200 x 390 x 700 mm
Barcode Number	5012713036325	5012713036769

TROLLEY JACKS LOW PROFILE

SIP 2.5 Ton 'Low-Profile' Trolley Jack ITEM NO: 03675

Designed with lower-profile vehicles in mind, and thus is able to operate under performance and sports cars in workshop and mobile applications. Ultra reliable.

Key Features:

- Extra-low profile design for low cars
- Safety bypass system protects cylinder
- Removable 2-piece handle with rubber grip
- Heavy-duty chassis for added reliability
- Large saddle with rubber contact pad
- Steel hydraulic block assembly



SIP SALES:

Tel: 01509 500500
Fax: 01509 500456
Email: sales@sip-group.com

TECHNICAL / AFTERSALES:

Tel: 01509 500400
Fax: 01509 500456
Email: technical@sip-group.com

MODEL	SIP 2.5 TON 'LOW-PROFILE' TROLLEY JACK
PRODUCT CODE	03675
Lifting Capacity	2.5 Ton
Min. Lifting Height	93 mm
Max. Lifting Height	490 mm
Saddle Size	95 x 95 mm
Construction	Steel
Low-Profile Design	✓
Quick-Lift Feature	✗
Wheel Mounted	✓
Weight	34 kg
Packaged Dimensions	200 x 390 x 700 mm
Barcode Number	5012713036752

SPECIFICATIONS

TROLLEY JACKS LOW PROFILE (HEAVY DUTY)

SIP 3.25 Ton ‘Low-Profile’ Trolley Jack ITEM NO: 03688

A heavy-duty trolley jack with a high lifting capacity, ideal for busy multi-purpose workshops and garages, including higher clearance and heavier vehicles. Strong steel construction.

Key Features:

- Low-profile design for various vehicles
- Efficient dual pumps for faster lifting
- Extra-large saddle and rubber pad
- Ideal for larger and heavier vehicles
- Extra-strong long padded handle
- Heavy-duty steel gauge base



MODEL	SIP 3.25 TON ‘LOW-PROFILE’ TROLLEY JACK
PRODUCT CODE	03688
Lifting Capacity	3.25 Ton
Min. Lifting Height	95 mm
Max. Lifting Height	520 mm
Saddle Size	120 mm
Construction	Steel
Low-Profile Design	✓
Quick-Lift Feature	✗
Wheel Mounted	✓
Weight	44.5 kg
Packaged Dimensions	190 x 405 x 815 mm
Barcode Number	5012713036882

SPECIFICATIONS

LONG FLOOR JACKS

SIP 5 Ton Long Floor Jack ITEM NO: 03642

SIP 10 Ton Long Floor Jack ITEM NO: 03647

These long floor jacks from SIP make lifting larger vehicles with heavier weights easier due to the Quick-Lift system they feature, a large contact saddle diameter, extra-long wheel base and strong handles.

Key Features:

- Quick-Lift system for efficient and faster lifting
- Integrated foot pedal raises the contact saddle
- Extra-long handle for various larger vehicles
- Rear toe plate for easy jack positioning
- Strong steel wheels and swivel castors
- Extra-large diameter contact saddle
- Release knob and handle lock



WHAT IS QUICK-LIFT?

The Quick-Lift system allows the quick raising of the jack saddle to the vehicle lifting point with minimal effort, therefore reducing overall operator strain and increasing efficiency.

MODEL	SIP 5 TON LONG FLOOR JACK	SIP 10 TON LONG FLOOR JACK
PRODUCT CODE	03642	03647
Lifting Capacity	5 Ton	10 Ton
Min. Lifting Height	150 mm	160 mm
Max. Lifting Height	560 mm	560 mm
Saddle Size	130 mm	150 mm
Construction	Steel	Steel
Low-Profile Design	✗	✗
Quick-Lift Feature	✓	✓
Wheel Mounted	✓	✓
Weight	87 kg	156 kg
Packaged Dimensions	340 x 420 x 1570 mm	300 x 520 x 1670 mm
Barcode Number	5012713036424	5012713036479

SPECIFICATIONS

PNEUMATIC FLOOR JACKS

SIP 22 Ton Pneumatic Air Floor Jack

ITEM NO: 03643

This floor jack boasts a maximum lifting height of over 500 mm - with screw extension - despite its low clearance design, allowing for versatile usage on a range of vehicles. Ideal for professional garages and for use with commercial vehicles.

Key Features:

- Quiet non-marking rubber wheels
- Air-line hook and air control valve
- Handle lock and release control
- Smooth pneumatically - assisted operation
- Adaptor models supplied with 3 quick-lift supports to increase starting height
- Ground ram saddle



Handle lock and release control



SIP 50/25/10 Ton Pneumatic Truck Jack

ITEM NO: 03649

A pneumatic jack designed for lifting heavy commercial vehicles such as trucks, lorries, large vans and more. A 3-stage lifting system can comfortably lift different weights to impressive heights.

Key Features:

- 3-stage lifting system up to 50 Tons;
Stage 1: 70 mm for 50 Ton weight
Stage 2: 55 mm for 25 Ton weight
Stage 3: 85 mm for 10 Ton weight
- Large rubber wheels for improved movement
- Compact lift assembly and long handle for maximum access
- Chrome-plated ram cylinder reduces abrasion and extends hydraulic seal life
- Air return provides smoother working action
- Integrated release safety handles
- Strong saddle to secure the load
- Solid and durable construction



Handle tilt release lever



Integrated release safety handle

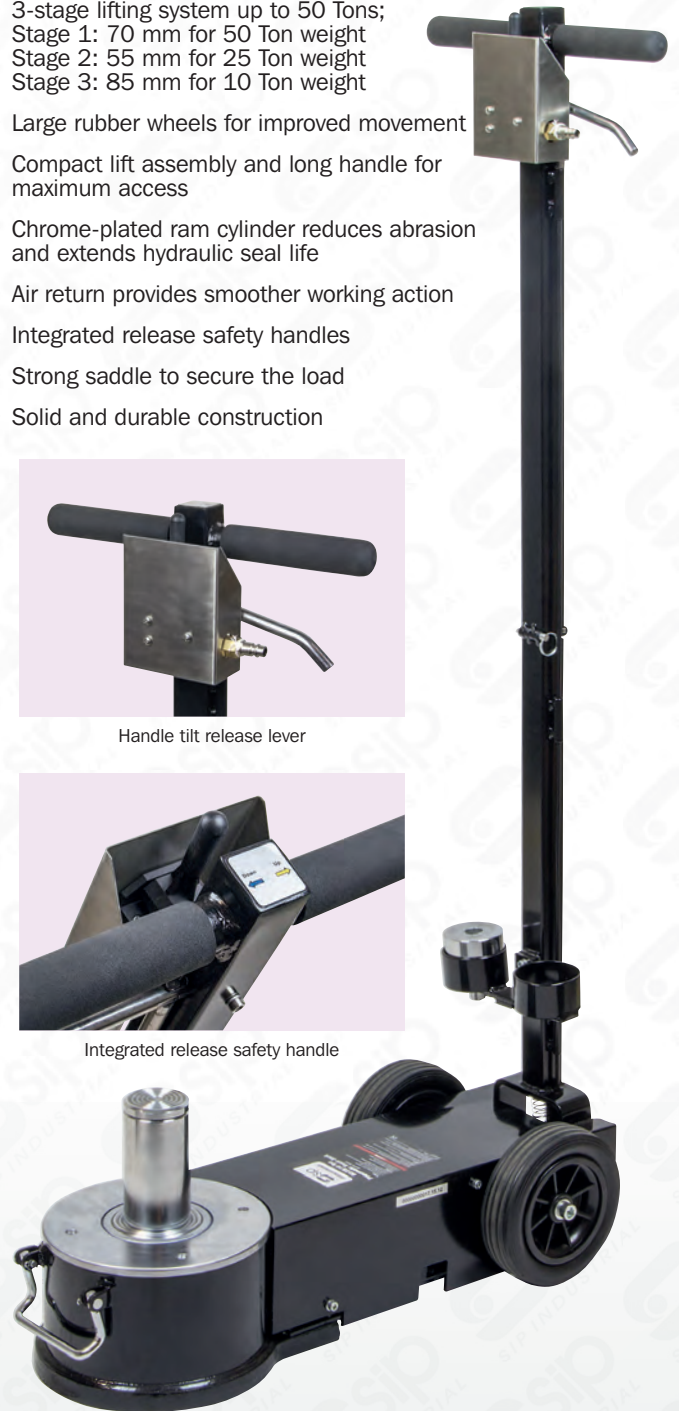

MODEL	SIP 22 TON PNEUMATIC AIR FLOOR JACK
PRODUCT CODE	03643
Lifting Capacity	5 Ton
Min. Lifting Height	230 mm
Max. Lifting Height	555 mm
Ram Stroke	130 mm
Adaptor Sizes Ø	20 x 50, 20 x 70, 50 x 50, 110 x 50 mm
Air Pressure	7 to 10 bar
Air Consumption	9.5 CFM
Wheel Mounted	✓
Weight	46 kg
Packaged Dimensions	280 x 360 x 630 mm
Barcode Number	5012713036431

SPECIFICATIONS

MODEL	SIP 50/25/10 TON PNEUMATIC TRUCK JACK
PRODUCT CODE	03649
Lifting Capacity	50 / 25 / 10 Ton
Min. Lifting Height	150 mm
Max. Lifting Height	360 mm
Ram Stroke	150 mm
Adaptor Sizes Ø	60 x 70, 120 x 70 mm
Air Pressure	100 to 145 psi
Air Consumption	✗
Wheel mounted	✓
Weight	68 kg
Packaged Dimensions	290 x 375 x 710 mm
Barcode Number	5012713036493

SPECIFICATIONS

TRANSMISSION JACKS

SIP 500 KG Transmission Jack ITEM NO: 03871

A solidly constructed transmission jack suitable for garage and workshop applications. A relatively lightweight build means easy movement across floors. Heavy-duty components designed for prolonged use in professional environments.

Key Features:

- Oversized foot pedal for easy lifting
- Spring-loaded pressure release valve
- Knurled air release valve
- Convenient foot pedal lifting
- Heavy-duty hydraulic cylinder
- New and improved design
- Heavy-duty swivel castors



Knurled air release valve



SIP 500 KG 'Quick-Lift' Transmission Jack ITEM NO: 03690

A durable transmission jack suitable for professional applications of all varieties. Heavy-duty components combined with a 'Quick-Lift' system ensure that up to 500kg can be lifted efficiently, without considerable strain from the operator.

Key Features:

- Large foot pedal for easy lifting
- Spring-loaded pressure release valve
- Large footprint base to spread the load
- Quick-Lift efficient lifting mechanism
- Heavy-duty steel wheels and castors
- Heavy-duty hydraulic cylinder
- Solid and durable construction



03869 ▶

SIP Transmission Adaptor ITEM NO: 03869

An adaptor for all SIP transmission jacks that provides stability and fully adjustable gearbox support. Ideal for heavy-duty and prolonged applications.

Key Features:

- 750 lbs maximum weight capacity
- Fully adjustable gearbox support
- Fine adjustment by manual screw rod
- Feet and twin spindles are adjustable over the whole length of the support
- Supplied with a double groove chain
- Suitable for all SIP transmission jacks
- 10.5 kg weight
- 130 x 220 x 350 mm packaged dimensions

Barcode Number: 5012713038695

MODEL	SIP 500 KG TRANSMISSION JACK	SIP 500 KG 'QUICK-LIFT' TRANSMISSION JACK
PRODUCT CODE	03871	03690
Lifting Capacity	500 kg	500 kg
Min. Lifting Height	1175 mm	1250 mm
Max. Lifting Height	1995 mm	2040 mm
Wheel Mounted	✓	✓
Weight	30 kg	40.1 kg
Packaged Dimensions	285 x 230 x 1125 mm	280 x 360 x 1090 mm
Barcode Number	5012713038718	5012713036905

SIP 1 Ton Transmission Jack with Adaptor

ITEM NO: 03693

A solidly constructed transmission jack suitable for garage and workshop applications. A relatively lightweight build means easy movement across floors. Heavy-duty components designed for prolonged use in professional environments.

Key Features:

- Solid heavy-duty wheels and castors
- Large solid base to spread the load
- Transmission adaptor included
- Spring-loaded release valve
- Durable hydraulic cylinder
- Heavy-duty swivel castors



Transmission adaptor included

MODEL	SIP 1 TON TRANSMISSION JACK
PRODUCT CODE	03693
Lifting Capacity	1 Ton
Min. Lifting Height	1258 mm
Max. Lifting Height	2145 mm
Wheel Mounted	✓
Weight	65 kg
Packaged Dimensions	280 x 350 x 1530 mm
Barcode Number	5012713036936

SPECIFICATIONS

SIP 3 Ton Jack Stands

ITEM NO: 03637

SIP 6 Ton Jack Stands

ITEM NO: 03641

Supplied in pairs of ultra-lightweight jacks stands, comfortably able to hold considerable weight due to strong construction and load-spreading design.

Key Features:

- Large feet to help spread the load evenly
- Ratchet action for quick and safe adjustment
- Suitable for garages and workshops
- Lightweight and relatively compact
- Strong and durable construction



03637



03641

MODEL	SIP 3 TON JACK STANDS	SIP 6 TON JACK STANDS
PRODUCT CODE	03637	03641
Lifting Capacity	3 Ton	6 Ton
Min. Lifting Height	238 mm	395 mm
Max. Lifting Height	372 mm	605 mm
Height Adjustment Type	Ratchet	Ratchet
Supplied in Pairs	✓	✓
Weight	8 kg	13.7 kg
Packaged Dimensions	220 x 220 x 360 mm	270 x 305 x 465 mm
Barcode Number	5012713036370	5012713036417

SPECIFICATIONS

BOTTLE JACKS

SIP 2 Ton Bottle Jack ITEM NO: 03666

SIP 4 Ton Bottle Jack ITEM NO: 03667

SIP 8 Ton Bottle Jack ITEM NO: 03668

SIP 12 Ton Bottle Jack ITEM NO: 03669

SIP 20 Ton Bottle Jack ITEM NO: 03670

SIP 30 Ton Bottle Jack ITEM NO: 03671

SIP 50 Ton Bottle Jack ITEM NO: 03672

All SIP Bottle Jacks boast a solid and durable construction regardless of their weight class, and come with screw extensions for adjustable starting heights (with exception to 03671/03672). Suitable for commercial vehicles, bending, and straightening.

Key Features:

- Durable and powerful construction • Compact, relatively lightweight design • Extensions for adjustable starting heights
- Integrated safety valves • Serrated contact saddles • Reliable overload protection • Heavy-duty cast iron bases

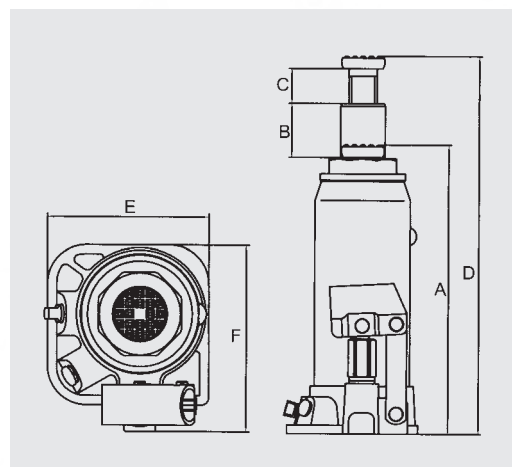

MODEL	Lifting Capacity	A	B	C	D	E	F	Weight	Packaged Dimensions	Barcode Number
03666	2 Ton	156 mm	100 mm	60 mm	320 mm	93 mm	88 mm	2.3 kg	120 x 100 x 175 mm	5012713036660
03667	4 Ton	182 mm	118 mm	60 mm	354 mm	102 mm	107 mm	3.2 kg	125 x 110 x 210 mm	5012713036677
03668	8 Ton	202 mm	136 mm	60 mm	400 mm	120 mm	120 mm	5.4 kg	140 x 130 x 210 mm	5012713036684
03669	12 Ton	213 mm	142 mm	60 mm	415 mm	132 mm	132 mm	7.2 kg	150 x 145 x 225 mm	5012713036691
03670	20 Ton	242 mm	166 mm	60 mm	470 mm	140 mm	140 mm	11 kg	180 x 165 x 255 mm	5012713036707
03671	30 Ton	288 mm	200 mm	-	489 mm	160 mm	160 mm	14.6 kg	180 x 180 x 295 mm	5012713036714
03672	50 Ton	298 mm	300 mm	-	494 mm	176 mm	176 mm	32 kg	240 x 220 x 320 mm	5012713036721

SIP 1 Ton Folding Engine Crane ITEM NO: 03685

SIP 2 Ton Folding Engine Crane ITEM NO: 03687

Two engine cranes suitable for lifting heavy-duty engines and other vehicle components. Their front legs and lifting booms are fully retractable, allowing for quick and easy storage, meaning that they do not use up unnecessary space in workshops and garages.

Key Features:

- Heavy-duty steel box construction
- Hydraulic pump with chromed ram
- Retractable booms and front legs
- 6 heavy-duty castors for easy movement
- 4-hole position boom for different weights
- Durable and reliable construction



4 hole position boom with indicated weight capacities

03685 ▶



Retractable boom and front legs allow for easy and convenient storage

SIP Engine Leveller ITEM NO: 03692

Features fine screw adjustment for levelling off-centre loads easily, ideal for car, van, truck, and marine engines or gearboxes.

Can be used with most cranes.

Key Features:

- Fine screw adjustment
- Supplied with chains
- 6.4 kg weight
- 445 x 64 x 190 mm packaged dimensions

Barcode Number:
50127130036929



6x heavy duty castors for smooth and easy movement

MODEL	SIP 1 TON ENGINE CRANE	SIP 2 TON ENGINE CRANE
PRODUCT CODE	03885	03687
Maximum Lifting Capacity	1 Ton	2 Ton
Position: 1	1000 kg	2000 kg
Position: 2	750 kg	1500 kg
Position: 3	500 kg	1000 kg
Position: 4	250 kg	500 kg
Ram Capacity	4 Ton	8 Ton
Maximum Lift Height	2000 mm	2000 mm
Wheel Mounted	✓	✓
Weight	71 kg	104.1 kg
Packaged Dimensions	200 x 385 x 1637 mm	90 x 610 x 880 mm (box 1) 170 x 320 x 1540 mm (box 2)
Barcode Number	5012713036855	5012713036875

ENGINE STAND, CAR CREEPER, WHEEL DOLLIES & CHOCKS

SIP 340 KG Engine Stand ITEM NO: 03681

A heavy-duty construction allows weight up to 750 lbs to be held comfortably, on a lightweight and compact frame that is fully adjustable and movable without strain on the user's part.

Key Features:

- Professional heavy-duty engine stand
- 360° rotating head to allow engine access
- 1x heavy-duty castor and 2x strong wheels
- Fully adjustable stand mounting arms
- Ideal for garages and workshops
- Lightweight and compact design
- Solid and durable construction



MODEL	SIP 340 KG ENGINE STAND
PRODUCT CODE	03681
Maximum Capacity	340 kg (750 lbs)
Head Rotation	360°
Wheel Mounted	✓
Weight	18.5 kg
Packaged Dimensions	190 x 195 x 875 mm
Barcode Number	5012713036813

SPECIFICATIONS

SIP Car Wheel Dollies ITEM NO: 03833

Constructed from heavy-duty pressed steel, these dollies are a simple solution to moving your car, able to lift 450kg, per dolly, comfortably despite their compact size. Supplied in pairs.

Key Features:

- 4 heavy-duty swivel castors for easy movement
- Ideal for garages and workshops
- Easy movement of cars and wheels
- Compact and lightweight build
- Superb value-for-money



MODEL	SIP CAR WHEEL DOLLIES
PRODUCT CODE	03833
Maximum Capacity	450 kg (per dolly)
Weight	18 kg (pair)
Packaged Dimensions	125 x 430 x 640 mm
Barcode Number	5012713038336

SPECIFICATIONS

SIP Car Creeper ITEM NO: 03639

A reliable and easy way of working under vehicles whilst reducing risk of strain or injury. Built for comfort and durability, thus an essential addition to any garage or workshop.

Key Features:

- Durable oil-resistant vinyl cover • Solid rectangular frame for added strength
- Fully padded back and adjustable angle head rest
- 6 heavy-duty swivel castors for optimum manoeuvrability
- Superb value-for-money • Weight: 8.2 kg
- 1040 x 440 x 125 mm packaged dimensions

Barcode Number: 5012713036394



SIP Wheel Chocks ITEM NO: 03636

Designed to ensure that no vehicle or component will move when being jacked, lifted or otherwise, meaning that general maintenance will be far safer. Ideal for heavy-duty use. Supplied in pairs.

Key Features:

- High-quality premium wheel chocks • Improves overall safety of any user
- Vehicles will not move during jacking • Essential for any workshop/garage
- Solid and durable construction • Ideal for heavy-duty usage
- 1.5 kg weight • 100 x 50 x 80 mm packaged dimensions

Barcode Number: 5012713036363



WHEEL REMOVAL TROLLEY & SPRING COMPRESSOR

SIP Wheel Removal Trolley ITEM NO: 03640

A convenient and safe solution for handling, removing, and mounting of wheels on large vehicles such as tractors and trucks. The construction allows for convenience and safe way to handle large and heavy components.

Key Features:

- 1.2 Ton capacity
- 8 adjustable rollers for easy wheel turning
- Locking mechanism fixes rollers in pre-set positions
- Mounted on 4 heavy-duty castors (2 locking type)
- Convenient and safe way to handle large wheels
- Perfect for taking off/mounting on big vehicles



SPECIFICATIONS

MODEL	SIP WHEEL REMOVAL TROLLEY
PRODUCT CODE	03640
Capacity	1.2 Ton
Max. Wheel Width Range	0 to 760 mm
Wheel Mounted	✓
Weight	137 kg
Packaged Dimensions	320 x 1030 x 1300 mm
Barcode Number	5012713036400

SIP Hydraulic Spring Compressor ITEM NO: 03638

Fast and easy operation when compared to other manual spring compressors available on the market. A compact design means no space is used unnecessarily, allowing for easy storage and movement.

Key Features:

- 1000 kg maximum weight capacity
- For use with 4" to 10" (101.6 to 254 mm) spring sizes
- Easy operation compared to other spring compressors
- Compact and lightweight construction
- Large base to help spread any weight
- Oversized foot pedal for quick lifting



SPECIFICATIONS

MODEL	SIP HYDRAULIC SPRING COMPRESSOR
PRODUCT CODE	03638
Capacity	1000 kg
Max. Working Length	480 mm
Ram Travel	325 mm
Spring Range Ø	101.6 to 254 mm (4" to 10")
Weight	37 kg
Packaged Dimensions	220 x 290 x 1230 mm
Barcode Number	5012713036387

BENCH AND FLOOR PRESSES

SIP 10 Ton Bench Press ITEM NO: 03650

SIP 12 Ton Shop Press ITEM NO: 03651

SIP 20 Ton Shop Press ITEM NO: 03689

SIP 30 Ton Shop Press ITEM NO: 03695

SIP 45 Ton Shop Press ITEM NO: 03691

SIP 75 Ton Shop Press ITEM NO: 03696

All are suitable for domestic, trade and professional workshops and garages. All machines have a rugged steel frame and are ideal for removal or installation of bearings, universal joints, pulleys, wrist pins, and other applications, such as bending, bonding, and straightening.

Bench and floor models available.

Key Features:

- Rugged steel frames for added durability
- Adjustable heights on durable workbeds
- Integrated glycerine-filled manometer



MODEL	SIP 10 TON BENCH PRESS	SIP 12 TON SHOP PRESS	SIP 20 TON SHOP PRESS	SIP 30 TON SHOP PRESS
PRODUCT CODE	03650	03651	03689	03695
Capacity	10 Ton	12 Ton	20 Ton	30 Ton
Ram Stroke	175 mm	175 mm	185 mm	150 mm
Minimum Work Height	0 mm	0 mm	0 mm	151 mm
Maximum Work Height	300 mm	300 mm	990 mm	1031 mm
Press Type	Bench	Floor	Floor	Floor
Operation Type	Manual	Manual	Manual	Pneumatic / Manual
Weight	52 kg	77 kg	112 kg	200 kg
Packaged Dimensions	150 x 540 x 790 mm	195 x 165 x 1375 mm (box 1) 150 x 220 x 660 mm (box 2)	150 x 185 x 1800 mm (box 1) 130 x 320 x 640 mm (box 2)	210 x 780 x 1900 mm
Barcode Number	5012713036509	5012713036516	5012713036899	5012713036950

BENCH AND FLOOR PRESSES



GLYCERINE FILLED
MANOMETER
INCLUDED

RUGGED STEEL
FRAME DESIGN

UNITS FEATURE
EITHER MANUAL
OR
PNEUMATIC /
MANUAL OPERATION

ADJUSTABLE WORK
BED HEIGHT

BENCH / SHOP
PRESSES



SIP 45 TON SHOP PRESS	SIP 75 TON SHOP PRESS
03691	03696
45 Ton	75 Ton
190 mm	260 mm
0 mm	170 mm
890 mm	884 mm
Floor	Floor
Pneumatic / Manual	Pneumatic / Manual
243 kg	498 kg
300 x 380 x 1656 mm	1100 x 330 x 2100 mm
5012713036912	5012713036967

SPECIFICATIONS

AUTO BODY REPAIR KIT, PIPE BENDER & TORQUE MULTIPLIER

SIP 10 Ton Auto Body Repair Kit ITEM NO: 03679

Designed primarily for straightening and aligning vehicle bodies and bodywork, and structural work for vehicles of various types. Features essential components for auto-body repair in garages and workshops.

Key Features:

- Polished hydraulic ram and cylinder to reduce abrasion
- Supplied in tough and durable steel storage and carry case
- Integrated safety valve

What's in the box?

10 Ton hand pump, 10 Ton ram, hose, spreader, rubber head, flat base, male adaptor, serrated saddle, plunger toe, ram toe, wedge head, 90° combination head and a selection of extension tubes.



SPECIFICATIONS

MODEL	SIP 10 TON BODY REPAIR KIT
PRODUCT CODE	03679
Ram Capacity	10 Ton
Minimum Ram Length	470 mm
Ram Stroke	53 mm
Weight	36 kg
Packaged Dimensions	165 x 430 x 815 mm
Barcode Number	5012713036790

SIP 12 Ton Hydraulic Pipe Bender (w/ Formers)

ITEM NO: 03683

A durable floor-standing hydraulic pipe bender, suitable for heavy-duty application in busy work environments. A sturdy steel construction ensures high quality and accurate bending each time.

Key Features:

- 12 Ton hydraulic ram
- Supplied with 6 versatile formers
- External industrial return springs and heavy duty steel chassis
- Ideal for garages and workshops



SPECIFICATIONS

MODEL	SIP 12 TON PIPE BENDER
PRODUCT CODE	03683
Ram Capacity	12 Ton
Former Sizes Ø	½", ¾", 1", 1½", 1½", 2"
Pipe Capacity Ø	½" to 2"
Weight	34.54 kg
Packaged Dimensions	125 x 430 x 640 mm
Barcode Number	5012713036837

SIP Professional Torque Multiplier ITEM NO: 06451

This multiplier will loosen the tightest wheel nut on trucks, lorries, vans, agricultural machines, and more. An essential tool for any good automotive garage or workshop.

Key Features:

- Compact design and maintenance free
- 1:56 high power gear ratio
- 3500 Nm maximum torque output
- Standard 1" drive size
- Complete with 32 and 33mm impact sockets
- Supplied in a heavy duty blow-moulded plastic carry/storage case



SPECIFICATIONS

MODEL	SIP PRO TORQUE MULTIPLIER
PRODUCT CODE	06451
Maximum Torque	3500 Nm (2573 ft/lbs)
Gear Ratio	1:56
Drive Size	1"
Sockets Included	32mm, 33 mm
Weight	7.36 kg
Packaged Dimensions	120 x 210 x 405 mm
Barcode Number	5012713064519

SIP 5 Gallon Parts Washer

ITEM NO: 06886

A compact 23 litre (5 Gallon) parts washer that can be mounted on benches and other surfaces, removing the need for a large machine taking up space in a smaller garage or workshop. Integrated safety features make this washer reliable.

Key Features:

- 136 litre/hr (30 gallons) pump rate
- Self-latching lid with fusible link - the lid will snap shut in event of a fire
- Space-saving and bench-mountable
- Sturdy tough steel construction



SPECIFICATIONS

MODEL	SIP 5 GALLON PARTS WASHER
PRODUCT CODE	06886
Supply	230 V
Motor	25 W
Washer Size	23 Litres (5 gallon)
Fluid Capacity	16 Litres (3.5 gallon)
Pump Rate	136 ltr/hr
Construction	Steel
Washer Type	Bench
Weight	7.5 kg
Packaged Dimensions	260 x 370 x 470 mm
Barcode Number	5012713068869

SIP 20 Gallon Parts Washer

ITEM NO: 03834

A large 90 litre (20 Gallon) parts washer that is independently floor-standing, while remaining compact and relatively lightweight. Ideal for bigger garages or workshops with a busy environment. Integrated safety features make this washer reliable.

Key Features:

- 136 litres/hr (30 gallons) pump rate
- Self-latching lid with fusible link - the lid will snap shut in event of a fire
- Space-saving and free floor-standing
- Sturdy and tough construction



Watch it in action!



SPECIFICATIONS

MODEL	SIP 20 GALLON PARTS WASHER
PRODUCT CODE	03834
Supply	230 V
Motor	25 W
Washer Size	90 Litres (20 gallon)
Fluid Capacity	136 Litres (30 gallon)
Pump Rate	136 ltr/hr
Construction	Steel
Washer Type	Floor
Weight	25.5 kg
Packaged Dimensions	330 x 560 x 790 mm
Barcode Number	5012713038343

SIP Sandblast Cabinet

ITEM NO: 03868

For all finishing and cleaning applications, this cabinet provides efficient blasting, and quickly removes unwanted debris, rust, paint from metal and wood surfaces. Strong and stable construction.

Key Features:

- One-piece seamless construction • Quick and efficient sandblasting
- Automatic air shut-off for safety • Durable steel construction
- Compact and lightweight

SPECIFICATIONS

MODEL	SIP SANDBLAST CABINET
PRODUCT CODE	03868
Supply	230 V
Average Air Consumption	7 CFM (283 ltr/min)
Maximum Working Pressure	125 psi (8.6 bar)
Media Capacity	7.5 Litres
Construction	Steel
Weight	18.5 kg
Packaged Dimensions	510 x 520 x 640 mm
Barcode Number	5012713038688



SIP Parts Washer Solvent

ITEM NO: 02382

For use with SIP parts washers.

- 10 litre container

Barcode Number: 501271323820



SIP Advanced Hydraulic Oil

ITEM NO: 02347

A specialist hydraulic oil developed specifically to meet the lubrication demands of most hydraulic applications.

- 1 litre container

Barcode Number: 5012713023479



SIP GRAVITY & SUCTION OIL DRAINERS

SIP 80 Litre Gravity Oil Drainer ITEM NO: 03700

SIP 80 Litre Gravity/Suction Oil Drainer ITEM NO: 03711

SIP 80 Litre Gravity/Suction Oil Drainer with Inspection Chamber ITEM NO: 03722

Oil drainers from SIP are available as both gravity and suction-fed versions. They are designed for the safe collection of waste oil from vehicle gearboxes, engines and various other components.

They are constructed from heavy-duty steel, and mounted on durable front wheels and rear swivel castors for easy movement and storage, and all models feature a large collection bowl and accompanying tank.

Ideal for heavy-duty use.

Key Features:

- 80 litre tanks and 20 litre collection trays
- Collects oils from engines or gearboxes
- Wheel/caster-mounted for easy movement
- 6x various diameter suction tubes included
- Oil level indicator tube on reservoir
- Rugged steel construction



**2 YEAR
WARRANTY**

MODEL	SIP 80 LITRE GRAVITY OIL DRAINER	SIP 80 LITRE GRAVITY/SUCTION OIL DRAINER	SIP 80 LITRE GRAVITY/SUCTION OIL DRAINER WITH INSPECTION CHAMBER
PRODUCT CODE	03700	03711	03722
Tank Capacity	80 Litres	80 Litres	80 Litres
Operation	Gravity	Gravity / Suction	Gravity / Suction
Collection Bowl Capacity	20 Litres	20 Litres	20 Litres
Inspection Chamber Capacity / Construction	n/a	n/a	11 Litres / Perspex
Minimum Height	1195 mm	1190 mm	1500 mm
Maximum Height	1810 mm	1810 mm	1810 mm
Working Oil Temperature (engine oil)	40°C to 60°C	40°C to 60°C	40°C to 60°C
Oil Discharge Pressure (ejection)	10 to 15 psi (0.7 to 1 bar)	10 to 15 psi (0.7 to 1 bar)	10 to 15 psi (0.7 to 1 bar)
Air Inlet Pressure (extraction)	n/a	87 to 116 psi (6 to 8 bar)	87 to 116 psi (6 to 8 bar)
Air Inlet Connection	1/4"	1/4"	1/4"
Wheel Mounted	✓	✓	✓
Weight	31 kg	33 kg	39 kg
Packaged Dimensions	550 x 440 x 1000 mm	430 x 560 x 1000 mm	560 x 430 x 1470 mm
Barcode Number	5012713037001	5012713037117	5012713037223

SIP GRAVITY & SUCTION OIL DRAINERS



03722 ▶

SIP SALES:

Tel: 01509 500500
Fax: 01509 500456
Email: sales@sip-group.com

TECHNICAL / AFTERSALES:

Tel: 01509 500400
Fax: 01509 500456
Email: technical@sip-group.com

**2 YEAR
WARRANTY**



Collector tray height adjustment

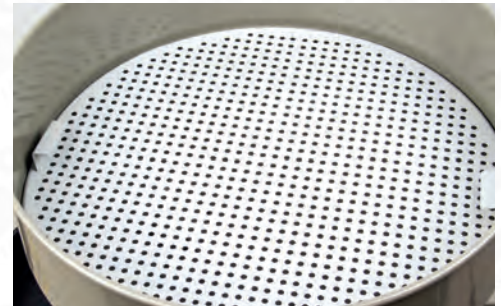

Large collector filler tray



Gravity / Suction switch-over lever



Selection of various diameter tubes included



Integrated suction tube cleaning wire

SIP BOOSTER PACKS

SIP Rescue Pac 1600 - 12v ITEM NO: 03936

Rechargeable 12v DC power supply.

Key Features:

- Rugged, durable case design
- 12v output socket
- Easy-to-use and ready for operation
- LED charge rate indication
- True 22Ah battery capacity
- Heavy duty leads and clamps

SPECIFICATIONS

MODEL	SIP RESCUE PAC 1600
PRODUCT CODE	03936
Battery Capacity	22 Ah
Output Voltage(s)	12 V
Boost Peak Rate	1600 A
Cranking Rate	700 A
Output Sockets	1x 12 V DC
Cable Length	800 mm
Weight	8.38 kg
Packaged Dimensions	275 x 100 x 440 mm
Barcode Number	5012713039364



SIP Rescue Pac 3000 - 12v/24v ITEM NO: 03937

Rechargeable 12v/24v DC power supply.

Key Features:

- Rugged, tough steel case with plastic seat
- True 2x 22Ah battery capacity
- 2x 12v output sockets
- Automatic circuit overload protection
- Reverse hook-up alarm and indication
- Heavy duty leads and clamps with rear storage hooks

SPECIFICATIONS

MODEL	SIP RESCUE PAC 3000
PRODUCT CODE	03937
Battery Capacity	22 Ah
Output Voltage(s)	12 V / 24 V
Boost Peak Rate	3000 A (12 V) / 1500 A (24 V)
Cranking Rate	1200 A (12 V) / 600 A (24 V)
Output Sockets	2x 12 V DC
Cable Length	1000 mm
Weight	19 kg
Packaged Dimensions	430 x 300 x 330 mm
Barcode Number	50127130039371



Neat rear storage hooks



SIP Pro Booster 802Li Multi-Functional Booster/Power Pac ITEM NO: 03973

Lithium-ion (LiFePO4) 20Ah battery with 800 A peak rate gives superior stability and higher cycle life than most conventional or Lithium batteries.

Key Features:

- Super powerful and compact - fits in a car glove box
- Suitable for up to 5 litre petrol / 3.5 litre diesel engines
- 2x USB (5 V) outputs - safely charge various electronics
- 12 V DC output socket
- LCD status display
- Laptop charging function
- Integrated LED work lights



SPECIFICATIONS

MODEL	SIP PRO BOOSTER 802LI
PRODUCT CODE	03973
Internal Battery	20,000 mAh LiFePO4
Boost Voltage	12 V
Start Current	500 A
Peak Current	800 A
Battery Life	2000 cycles
AC Charger (input)	230 V ~ 50 Hz
AC Charger (output)	15 V DC, 1 A
Working Temperature	-20°C to 40°C
Auxiliary Outputs	2x USB: 5 V, 1x Laptop: 19 V, 1x 12 V
Weight	1.12 kg
Packaged Dimensions	75 x 145 x 225 mm
Barcode Number	5012713039739



SIP PRO BOOSTER PACKS

SIP Pro Booster 2513 - 12v ITEM NO: 07172

SIP Pro Booster 3100 - 12v ITEM NO: 07173

Swiss made with tough impact resistant plastic casing. Suitable for professional use in busy automotive workshops and garages.

Key Features:

- Reverse polarity protection
- Copper cored charge cable and heavy duty crocodile clamps
- LED charge rate indication
- Complete with mains fast charger
- 12 month battery warranty
- 1x 12 V DC output socket



LED charge level indication



MODEL	SIP PRO BOOSTER 2513	SIP PRO BOOSTER 3100
PRODUCT CODE	07172	07173
Internal Battery Voltage	12 V	12 V
Battery Capacity	22 Ah	25 Ah
Boost Peak Rate	2500 A	3100 A
Cranking Rate	840 A	940 A
Output Sockets	1x 12 V DC	1x 12 V DC
Cable Length	1500 mm	1500 mm
Cable Diameter	25 mm ² copper	25 mm ² copper
Battery Warranty	12 months	12 months
Weight	11.58 kg	13.44 kg
Packaged Dimensions	500 x 290 x 170 mm	515 x 285 x 160 mm
Barcode Number	5012713071722	5012713071739

SPECIFICATIONS

SIP PRO BOOSTER PACKS

SIP Pro Booster 5024 - 12v/24v ITEM NO: 07192

Swiss made with tough impact resistant plastic casing. Suitable for professional use in busy automotive workshops and garages.

Key Features:

- Reverse polarity protection
- 12 month battery warranty
- Copper cored charge cable and heavy duty crocodile clamps
- 1x 12 V DC output socket
- Digital charge rate indication
- Complete with mains fast charger

SPECIFICATIONS

MODEL	SIP PRO BOOSTER 2513
PRODUCT CODE	07192
Internal Battery Voltage	12 V / 24 V
Battery Capacity	2x 22 Ah
Boost Peak Rate	5000 A (12 V) / 2500 A (24 V)
Cranking Rate	1680 A (12 V) / 840 A (24 V)
Output Sockets	1x 12 V DC
Cable Length	1300 mm
Cable Diameter	50 mm ² copper
Battery Warranty	12 months
Weight	17.5 kg
Packaged Dimensions	510 x 340 x 220 mm
Barcode Number	5012713071920



SIP Pro Booster 6200 - 12v/24v ITEM NO: 07174

Swiss made with tough impact resistant plastic casing. Designed for jump starting engines up to **550hp**.

Key Features:

- Reverse polarity protection
- 12 month battery warranty
- Copper cored charge cable and heavy duty crocodile clamps
- 1x 12 V DC output socket
- Digital charge rate indication
- Complete with mains fast charger

SPECIFICATIONS

MODEL	SIP PRO BOOSTER 6200
PRODUCT CODE	07174
Internal Battery Voltage	12 V / 24 V
Battery Capacity	2x 26 Ah
Boost Peak Rate	6200 A (12 V) / 3100 A (24 V)
Cranking Rate	1880 A (12 V) / 940 A (24 V)
Output Sockets	1x 12 V DC
Cable Length	1200 mm
Cable Diameter	40 mm ² copper
Battery Warranty	12 months
Weight	26 kg
Packaged Dimensions	625 x 360 x 235 mm
Barcode Number	5012713071746



SIP SC Booster 9000 - Capacitor ITEM NO: 07199

Swiss-made capacitor constructed with tough impact-resistant plastic casing. Large industrial brass clamps and copper cables ensure added durability and reliability.

Key Features:

- Reverse polarity protection
- Complete with mains fast charger
- Copper cored charge cable and heavy duty crocodile clamps
- 12 month battery warranty
- 1x 12 V DC output socket
- Digital charge rate indication

SPECIFICATIONS

MODEL	SIP SC BOOSTER 9000
PRODUCT CODE	07199
Internal Battery Voltage	12 V
Capacitors	500F Ultra
Boost Peak Rate	9000 A
Cranking Rate	1800 A
Cable Diameter	30 mm ² copper
Clamp Material	Brass
Weight	9 kg
Packaged Dimensions	500 x 340 x 220 mm
Barcode Number	5012713071999



SIP BATTERY CHARGER & POWER SUPPLY

SIP Chargestar 100BSU Battery Charger & Power Supply ITEM NO: 07182

Powered from a 230V 13A supply, the **Battery Support Unit & Charger** houses a micro-processor control circuitry with **High Current Handling** capacity.

Producing up to **100 A** power for **Vehicle Flash Reprogramming** and with a **70 A variable charging capability**.

All setting selections are made using the quality touch pad on the machine panel, enabling accurate and positive incremental adjustment.

Key Features:

- Up to 100 A power supply, maintaining stable voltage during ECU reprogramming and diagnostics
- 70 A battery charger
- Voltage settings between 13 - 14.8V for programming
- Fully auto charger for: SLA, AGM, GEL, calcium, Stop-Start batteries
- Variable charge rates
- Manual mode with digital timer
- Dual temperature controlled cooling fans
- 5 metre heavy-duty cable, clamps and Anderson plug
- Fully adjustable mounting brackets
- Durable, hard wearing aluminium case with large carry handle and Anderson socket



BATTERY CHARGER

HEAVY DUTY ANDERSON SOCKET

3 YEAR WARRANTY

Supplied with heavy duty cables and clamps, with adjustable mounting brackets

MODEL	SIP CHARGESTAR 100BSU
PRODUCT CODE	07182
Input Voltage	230 V (13 A)
OPERATION MODES:	
Flash Reprogram - Battery Support	13 - 14.8 V; 70 A continuous current: 100 A for 3 mins
Control Circuit	Microprocessor stabilised output
Charge Voltage	12 V
Automatic Charge	Up to 70 A charge current
Manual Charge	4 A, 20 A and 70 A
Battery Types	All Lead Acid (AGM, GEL etc) Calcium
Battery Recognition	From 0.3 V
Forced Cooling	Dual Fans
Insulation	IP20
Temperature Range	-20°C to 40°C
Weight	4.75 kg
Packaged Dimensions	324 x 108 x 235 mm
Barcode Number	5012713071821

SPECIFICATIONS

BATTERY CHARGERS

SIP Chargestar Smart 4 ITEM NO: 03979

SIP Chargestar Smart 8 ITEM NO: 03980

SIP Chargestar Smart battery chargers are highly versatile, owing to a 9-stage charging system suitable for a range of battery types, but are highly lightweight and compact.

Key Features:

- Standard 230v supplies
- 9-stage automatic charging system
- Bulk, pulse, recovery and further functions
- Suitable for SLA, AGM, GEL, VRLA batteries
- Fully automatic battery sensing
- Integrated LCD shows charge status
- May recover slightly sulphated batteries
- Durable heavy-duty construction



BATTERY CHARGERS



Clear and easy-to-use control panel

MODEL	SIP CHARGESTAR SMART 4	SIP CHARGESTAR SMART 8
PRODUCT CODE	03979	03980
Supply	230 V (13 A)	230 V (13 A)
Charging Voltage(s)	6 V / 12 V	12 V
Maximum Rated Current Output	4 A	8 A
Charge Rate Settings	Automatic: 3 stage @ 6 V / 9 stage @ 12 V	Automatic: 9 stage
Rated Battery Capacity	10 - 80 Ah	20 - 160 Ah
Battery Type(s)	Lead Acid - Gel, AGM, Wet Cell	Lead Acid - Gel, AGM, Wet Cell
Degree of Protection	IPX0	IPX0
Insulation	Class 2	Class 2
Weight	0.6 kg	0.84 kg
Packaged Dimensions	270 x 140 x 60 mm	280 x 145 x 70 mm
Barcode Number	5012713039791	5012713039807

SPECIFICATIONS

SIP Chargestar Smart 18 Battery Charger & Maintainer ITEM NO: 03981

Dual voltage battery charger with a 3-stage charge programme suitable for a range of batteries, providing superior versatility to other battery chargers. Various protections ensure long life and optimum performance.

Key Features:

- Reliable 100% rated output
- Fast and deep charge modes
- Integrated overcharge protection
- Short circuit prevention systems
- 3-stage charging programme for WET, AGM, and GEL batteries
- Solid and durable construction

SPECIFICATIONS

MODEL	SIP CHARGESTAR SMART 18
PRODUCT CODE	03981
Supply	230 V (13 A)
Charging Voltage(s)	6 V / 12 V
Charge Rate Settings	2
Maximum Rated Current Output (slow)	2 A
Maximum Rated Current Output (fast)	12 A
Rated Battery Capacity	4 to 160 Ah
Battery Type(s)	GEL, AGM, WET Cell
Degree of Protection	Overcharge, short circuit
Weight	1 kg
Packaged Dimensions	200 x 150 x 175 mm
Barcode Number	5012713039814



BATTERY CHARGER

SIP Chargestar T27 ITEM NO: 03982

Dual voltage battery charger with multiple charge rate settings suitable for a range of batteries, providing superior versatility to other battery chargers. Housed in a solid casing for long life and top performance.

Key Features:

- Dual voltage battery charger
- Suitable for lead acid batteries and more
- Two charge rate settings for added choice
- Integrated ammeter for clearer levels
- Powerful and lightweight unit
- Standard IP20 protection

SPECIFICATIONS

MODEL	SIP CHARGESTAR T27
PRODUCT CODE	03982
Supply	230 V (13 A)
Charging Voltage(s)	12 V / 24 V
Charge Rate Settings	2
Maximum Rated Current Output (slow)	8.5 A (12 V) / 9 A (24 V)
Maximum Rated Current Output (fast)	11 A (12 V) / 14 A (24 V)
Boost Charge	22.5 A (12 V) / 24 A (24 V)
Rated Battery Capacity	40 to 240 Ah
Battery Type(s)	Lead Acid
Degree of Protection	IP20
Weight	6.5 kg
Packaged Dimensions	270 x 320 x 310 mm
Barcode Number	5012713039821



PROFESSIONAL BATTERY CHARGERS

SIP Chargestar Auto 40 ITEM NO: 03974

An easy-to-use unit ready for a range of trade of professional applications. Inverter technology and versatile charging functions mean a longer service life than other chargers of this type.

Key Features:

- Three different charging modes available:
 - 1) Manual: it allows the user to select battery voltage (12v or 24v); type of battery to charge; maximum charging current, maximum charging time; and de-sulphation phase
 - 2) Automatic charging from saved parameters; the user has the possibility to store their ideal charging settings and recall them automatically
 - 3) Automatic mode; the charge will be completely automatic once the user pressed the START button
- 12v 10 A battery support / stabiliser
- The charge function is carried out without output voltage peaks, which could damage the electronics fitted on motor vehicles
- Bespoke software enables charging of AGM, GEL, calcium and lead batteries for modern vehicles
- Premium quality Inverter technology
- Equipped with digital ammeter and voltmeter
- Charge current selector and polarity reversal
- Thermal overload and short circuit protection
- Battery charge voltage and alternator tester
- Integrated charge timer



Digital charging volts read-out



Digital charging volts read-out



Integrated charge timer



2 YEAR WARRANTY

SPECIFICATIONS

MODEL	SIP CHARGESTAR AUTO 40
PRODUCT CODE	03974
Supply	230 V (13 A)
Charging Voltage(s)	12 V / 24 V
Rated Battery Capacity	600 Ah
Maximum Rated Current Output	40 A (12 V) / 20 A (24 V)
Charge Rate Settings	40 A Infinitely Variable @ 12 V 20 A Infinitely Variable @ 24 V
Battery Type(s)	Lead Acid, AGM, GEL, Calcium
Degree of Protection	IP20
Insulation	Class F
Weight	4 kg
Packaged Dimensions	315 x 115 x 225 mm
Barcode Number	5012713039746

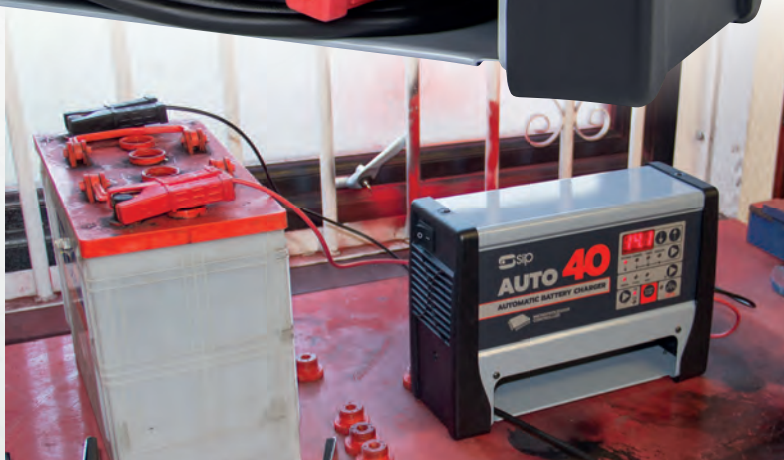

PROFESSIONAL BATTERY CHARGERS

SIP Chargestar P24 ITEM NO: 05530

SIP Chargestar P32 ITEM NO: 05531

Premium Italian-built battery chargers manufactured with heavy-duty charge leads and crocodile clips, ensuring longer life and lasting performance. Tough steel casing across the range.

Key Features:

- Perfect for garages and workshops
- Reliable reverse polarity protection
- Built-in ammeter for clear levels
- 2 different charge rate settings
- Heavy-duty leads and clips
- Premium Italian design



MODEL	SIP CHARGESTAR P24	SIP CHARGESTAR P32
PRODUCT CODE	05530	05531
Supply	230 V (13 A)	230 V (13 A)
Charging Voltage(s)	12 V / 24 V	12 V / 24 V
Rated Battery Capacity	85 Ah	110 Ah
Rated Current Output	8.5 A	11 A
Maximum Rated Current Output	12.5 A	16 A
Charge Rate Settings	2	2
Degree of Protection	IP20	IP20
Insulation	Class F	Class F
Weight	5.38 kg	7.12 kg
Packaged Dimensions	215 x 265 x 300 mm	215 x 265 x 300 mm
Barcode Number	5012713055302	5012713055319



**2 YEAR
WARRANTY**

BATTERY
CHARGER

SPECIFICATIONS

PROFESSIONAL STARTER / CHARGERS

SIP Startmaster P300 ITEM NO: 05532

SIP Startmaster P440 ITEM NO: 05533

A reliable range of professional battery starter / chargers, suitable for professional-grade application and tradesmen. Heavy duty charge leads and crocodile clips are standard, ensuring longer life and lasting performance. Tough steel casing.

Key Features:

- Dual voltage charging for high versatility
- Perfect for busy garages and workshops
- Reliable reverse polarity protection
- Built-in ammeter for clear levels
- Multiple charge rate settings
- Heavy-duty leads and clips
- Premium Italian design



◀ 05532



05533 ▶



**2 YEAR
WARRANTY**

SIP SALES:

Tel: 01509 500500
Fax: 01509 500456
Email: sales@sip-group.com

TECHNICAL / AFTERSALES:

Tel: 01509 500400
Fax: 01509 500456
Email: technical@sip-group.com

MODEL	SIP STARTMASTER P300	SIP STARTMASTER P440
PRODUCT CODE	05532	05533
Supply	230 V (13 A)	230 V (13 A)
Charging Voltage(s)	12 V	12 V / 24 V
Maximum Rated Battery Capacity	160 Ah	180 Ah
Rated Current Output	14 A	22 A
Maximum Rated Charge Output	20 A	33 A
Boost @ 1V/c	85 A	135 A
Maximum Boost	150 A	220 A
Charge Rate Settings	2	2
Degree of Protection	IP20	IP20
Insulation	Class F	Class F
Weight	6.58 kg	12.7 kg
Packaged Dimensions	245 x 265 x 300 mm	315 x 295 x 410 mm
Barcode Number	5012713055326	5012713055333

SPECIFICATIONS

PROFESSIONAL STARTER / CHARGERS

- SIP Startmaster PW520** ITEM NO: 05534
SIP Startmaster PW600 ITEM NO: 05536
SIP Startmaster PW760 ITEM NO: 05537
SIP Startmaster PWT1000 ITEM NO: 05538
SIP Startmaster PWT1400 ITEM NO: 05539

Wheel mounted professional battery starter / chargers, suitable for professional-grade application and tradesmen.

Key Features:

- Variable charge timer facility for added convenience (items: 05538 and 05539)
- Remote lead for one-man operation (item: 05539)



05539 ▶



05534 ▶



05537 ▶



**2 YEAR
WARRANTY**

MODEL	SIP STARTMASTER PW520	SIP STARTMASTER PW600	SIP STARTMASTER PW760	SIP STARTMASTER PWT1000	SIP STARTMASTER PWT1400
PRODUCT CODE	05534	05536	05537	05538	05539
Supply	230 V (13 A)	230 V (16 A)	230 V (20 A)	230 V (25 A)	230 V (40 A)
Charging Voltage(s)	12 V / 24 V	12 V / 24 V	12 V / 24 V	12 V / 24 V	12 V / 24 V
Maximum Rated Battery Capacity	200 Ah	280 Ah	340 Ah	370 Ah	400 Ah
Rated Current Output	25 A	30 A	38 A	45 A	60 A
Maximum Rated Charge Output	42 A	45 A	57 A	68 A	90 A
Boost @ 1V/c	145 A	200 A	260 A	330 A	400 A
Maximum Boost	260 A	300 A	380 A	500 A	700 A
Charge Rate Settings	3	3	3	6	6
Timer	✗	✗	✗	✓	✓
Remote Start	✗	✗	✗	✗	✓
Wheel Mounted	✓	✓	✓	✓	✓
Degree of Protection	IP20	IP20	IP20	IP20	IP20
Insulation	Class F	Class F	Class F	Class F	Class F
Weight	21 kg	21 kg	25 kg	29 kg	32 kg
Packaged Dimensions	360 x 400 x 700 mm	360 x 400 x 700 mm	360 x 400 x 700 mm	370 x 390 x 745 mm	370 x 390 x 745 mm
Barcode Number	5012713055340	5012713055364	5012713055371	5012713055388	5012713055395

SPECIFICATIONS

PROFESSIONAL STARTER / CHARGERS

SIP Startmaster PWT5000 Digital ITEM NO: 05542

Part of a new generation of professional of battery charging, featuring electronic over-voltage protections in the charge and boost functions. This charger is capable of starting modern motor vehicles, avoiding the risk of damages to the vehicle's electronic devices.

Key Features:

- "One-man" boost operation
- Separate timer function for both charge and boost settings
- Digital current regulation in 2 modes
- Ideal for AGM, GEL, calcium and lead acid
- Integrated digital ammeter and charge timer
- Can start modern motor vehicles, avoiding risk of damage to vehicle's electronic devices
- Thermal overload and short circuit protection
- Equipped with a charge current selector
- Polarity reversal and internal fuse



Clear and easy-to-use control panel



**2 YEAR
WARRANTY**

SPECIFICATIONS

MODEL	SIP STARTMASTER PWT5000 DIGITAL
PRODUCT CODE	05542
Supply	230 V (13 A)
Charging Voltage(s)	12 V / 24 V
Maximum Rated Battery Capacity	540 Ah
Rated Current Output	36 A @ 12 V / 27.5 A @ 24 V
Maximum Rated Charge Output	55 A Infinitely Variable @ 12 V 18 A Infinitely Variable @ 24 V
Boost @ 1V/c	260 A
Maximum Boost	350 A
Timer	Separate Charge and Boost setting
Remote Start	✓
Wheel Mounted	✓
Degree of Protection	IP20
Insulation	Class F
Weight	20.9 kg
Packaged Dimensions	650 x 415 x 260 mm
Barcode Number	5012713055425

Available NOW!

Coming soon....

PRODUCT
CATALOGUE

WELDING
METALWORK

PRODUCT
CATALOGUE

AIR COMPRESSORS
AIR TOOLS

PRODUCT
CATALOGUE

WOODWORKING

PRODUCT
CATALOGUE

HEATING & FANS
GENERATORS
PRESSURE
WASHERS
WATER PUMPS

Conversion Tables

Millimetres to Inches

Millimetres (mm)	Inches (ins)	Millimetres (mm)	Inches (ins)	Millimetres (mm)	Inches (ins)	Millimetres (mm)	Inches (ins)
1	0.039	7	0.276	40	1.575	100	3.937
2	0.079	8	0.315	50	1.969	200	7.874
3	0.118	9	0.354	60	2.362	300	11.811
4	0.157	10	0.394	70	2.756	400	15.748
5	0.197	20	0.787	80	3.150	500	19.685
6	0.236	30	1.181	90	3.543	1000	39.37

Metres to Feet

Metres (m)	Feet (ft)	Metres (m)	Feet (ft)	Metres (m)	Feet (ft)	Metres (m)	Feet (ft)
1	3.281	6	19.685	20	65.617	70	229.659
2	6.562	7	22.966	30	98.425	80	262.467
3	9.843	8	26.247	40	131.234	90	295.276
4	13.123	9	29.528	50	164.042	100	328.084
5	16.404	10	32.808	60	196.85		

Bar to PSI

Bar	PSI	Bar	PSI	Bar	PSI	Bar	PSI
1	14.5	6	87.02	20	290.1	70	1015
2	29.01	7	101.5	30	435.1	80	1160
3	43.51	8	116	40	580.2	90	1305
4	58.02	9	130.5	50	725.2	100	1450
5	72.52	10	145	60	870.2	150	2176

Kilograms to Stones/Pounds/Ounces

Kilograms (kg)	Stones/lbs/oz	Kilograms (kg)	Stones/lbs/oz	Kilograms (kg)	Stones/lbs/oz	Kilograms (kg)	Stones/lbs/oz
1	2 lb 3 oz	10	1 st 8 lbs	60	9st 6lbs	200	31st 69lb
2	4 lb 6 oz	20	3 st 2 lb	70	11st 00lb	300	47st 34lb
4	8 lb 13 oz	30	4 st 10 lbs	80	12st 8lb	400	62st 138lb
6	13 lb 3 oz	40	6st 4lbs	90	14st 2lb	500	78st 103lb
8	1 st 3 lb 10 oz	50	7st12lbs	100	15st10lb	1000	157st 66lb

Horsepower to Kilowatt

Horsepower (HP)	Kilowatt (kW)	Horsepower (HP)	Kilowatt (kW)	Horsepower (HP)	Kilowatt (kW)
1	0.746	6	4.474	11	8.203
2	1.491	7	5.220	12	8.948
3	2.237	8	5.966	13	9.694
4	2.983	9	6.711	14	10.440
5	3.729	10	7.457	15	11.186

Conversion Guide

To Convert From:	Multiply By	To Convert To:
Bar	14.503	PSI - Pounds per sq. inch
PSI - Pounds per sq. inch	0.069	Bar
L/s - Litres per second	2.119	CFM - Cubic feet per minute
CFM - Cubic feet per minute	0.472	L/s - litres per seconds
L/m - litres per minute	0.035	CFM - Cubic feet per minute
CFM - Cubic feet per minute	28.316	L/min - Litres per minute
Kilowatts (kW)	1.34	Horsepower (hp)
	100	Centimetre (cm)
Metres (m)	3.281	Feet (ft)
	39.37	Inches (in.)
	1.094	Yards (yd)
	0.1	Centimetres (cm)
Millimetres (mm)	0.039	Inches (in)
	0.001	Metres (m)
Pounds (lb)	0.454	Kilograms (kg)
Kilograms (kg)	2.205	Pounds (lb)

SIP (INDUSTRIAL PRODUCTS) LIMITED

Gelders Hall Road, Shepshed, Loughborough, Leicestershire LE12 9NH UK

www.sip-group.com



GENERAL ENQUIRIES

Tel: 01509 500300

Fax: 01509 503154

TECHNICAL / AFTER-SALES SERVICE

Tel: 01509 500400

Fax: 01509 500456

Email: technical@sip-group.com

SALES

Tel: 01509 500500

Fax: 01509 500456

Email: sales@sip-group.com

EXPORT

Tel: +44 (0)1509 500321

Fax: +44 (0)1509 500333

Email: export@sipindustrial.com



Facebook: www.facebook.com/sipindustrial

Twitter: @sipindustrial

YouTube: www.youtube.com/siptechzone



CAT No: 00153

Every reasonable effort is made to present current and accurate information at the time of print. However, SIP do reserve the right to change details or specifications without prior notice. Photographs are for illustration purposes only.

E & OE. Contents and images are copyright © SIP Ltd. and cannot be reproduced without express written permission.

Design, photography & illustration by SIP Design

Job No.: MB01153-12-17



PROUD PRODUCT SPONSOR